

The use of this document / drawing, and the information therein, is an acceptance of the following statements:

This document is copyright and must not be reproduced, completely or in part, without the consent of Seymour Architecture Ltd.

The controlled version of this document / drawing should be viewed in PDF.

This document / drawing may be based upon information supplied by third parties and as such their accuracy cannot be guaranteed.

This document / drawing may be based upon the requirement to be read in conjunction with other documentation and thus may not be relied upon solely.

Any discrepancies in document / drawing should be reported in writing to Seymour Architecture before proceeding.

All work must be carried out in accordance with current and relevant statutory and regulatory standards including Construction (Design & Management) Regulations.

This document / drawing was generated from the model:
254-SArch-S5-6CS-M3-A-Building_Central-211028

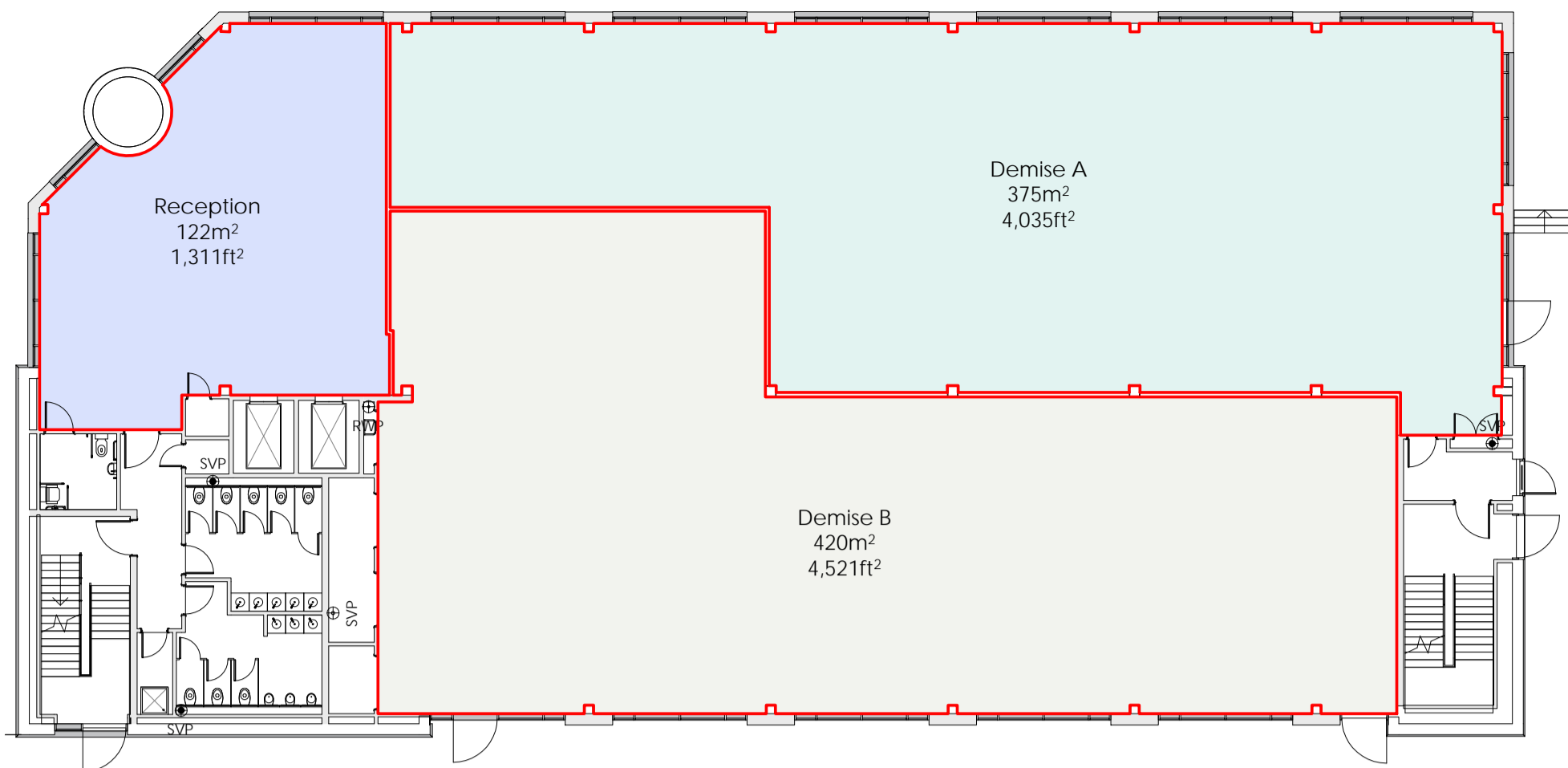

00 - Ground Floor - Demise
1 : 200

Area Schedule (NIA) by Demise		
Demise	NIA Area	NIA Area (sqft)
Reception	122 m ²	1,311 ft ²
Ground Floor Demise A	375 m ²	4,035 ft ²
Ground Floor Demise B	420 m ²	4,521 ft ²
First Floor Demise A	914 m ²	9,840 ft ²
Second Floor Demise A	931 m ²	10,023 ft ²
Third Floor Demise C	939 m ²	10,110 ft ²
Grand total:	3,701 m ²	39,840 ft ²

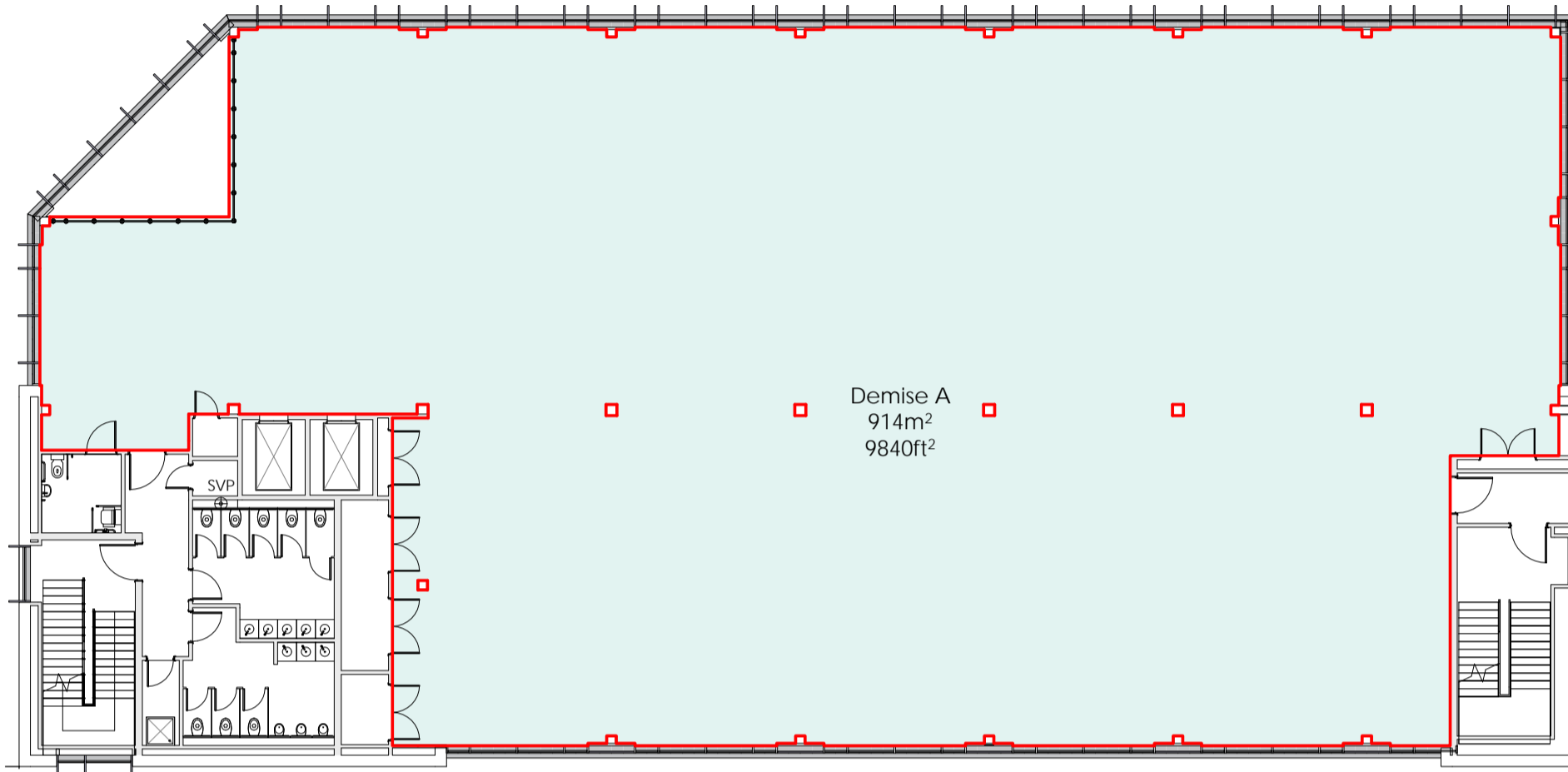

01 - First Floor - Demise
1 : 200

Area Schedule (NIA) Axa		
Demise	NIA Area	NIA Area (sqft)
Ground Floor Demise A	375 m ²	4,035 ft ²
First Floor Demise A	914 m ²	9,840 ft ²
Second Floor Demise A	931 m ²	10,023 ft ²
Total:	2,220 m ²	23,898 ft ²

Area Schedule (NIA) Axa Option		
Demise	NIA Area	NIA Area (sqft)
Ground Floor Demise B	420 m ²	4,521 ft ²

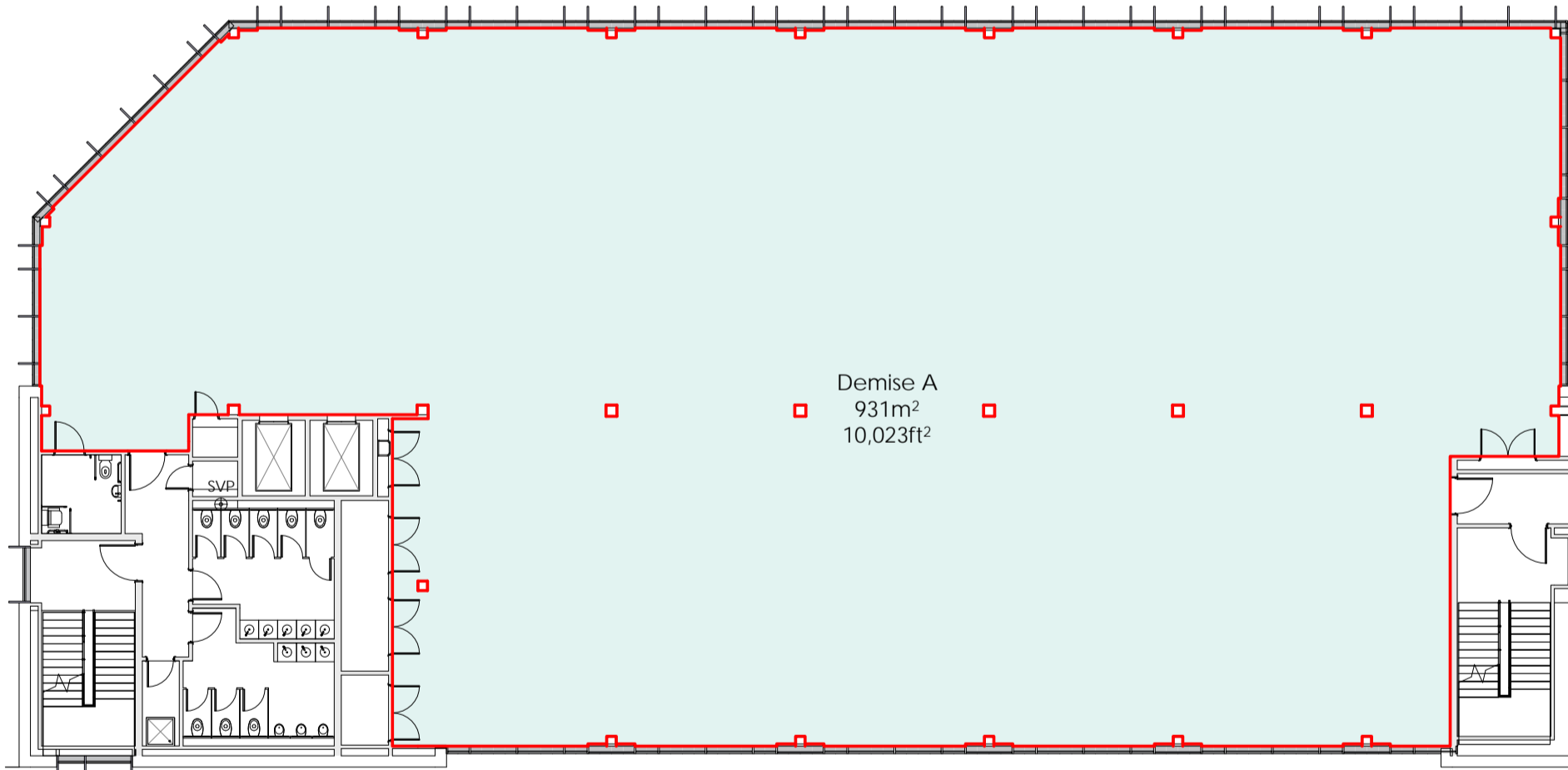

02 - Second Floor - Demise
1 : 200

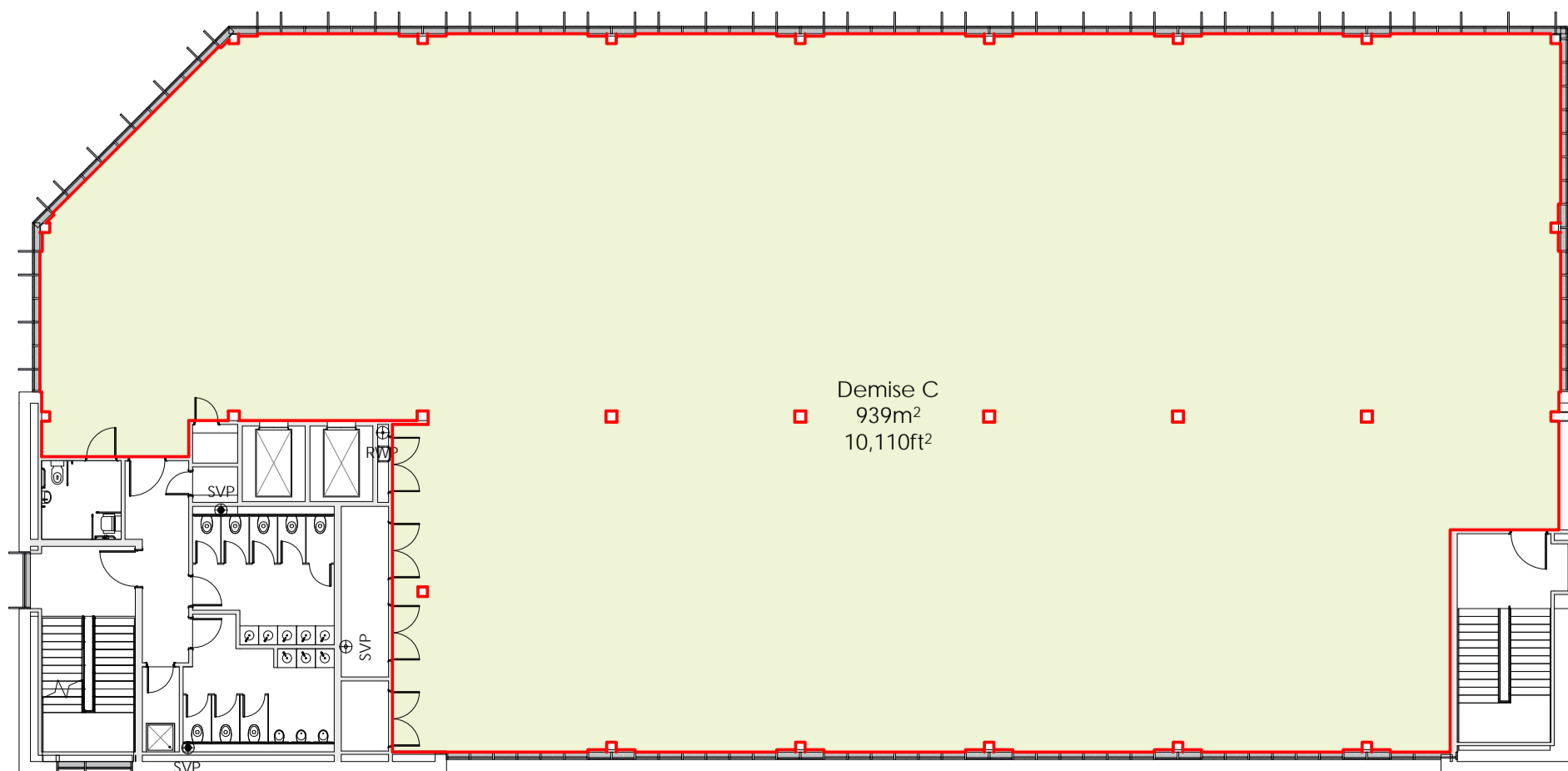

03 - Third Floor - Demise
1 : 200

Revision	Date	Description	Issued by
P09	05.11.21	Updated following client comment	SSa
P08	04.11.21	Updated following client comments.	SSa
P07	28.10.21	Total area corrected	SSa
P06	28.10.21	Updated in line with comments received	SSa
P04	04.10.21	Schedule updated to read 0 decimal places	SSa
P03	04.10.21	Annotated areas removed from floor plans for clarity	SSa
P02	20.08.21	Updated to include Demise B for expansion space	SSa
P01	19.08.21	First Issue	SSa
P05	26.10.21	Demise C areas added	ABO

Information Issue
RIBA Stage 5: Construction

Project
Ashall Projects (MB) Ltd
6 Centre Square
Middlesbrough

Drawing
Demise A

Drawing No.
254 - SArch - S5 - ZZ - DR - A - 2251 - P09

Scale at A2
As indicated

Drawn By
ABO

seymour
architecture

info@seymourarchitecture.com
www.seymourarchitecture.com
T 01670 517125